

RIGHT ANGLE PLUG CRIMP TYPE

CABLE 8.07/50

R161.194.000

Series : N

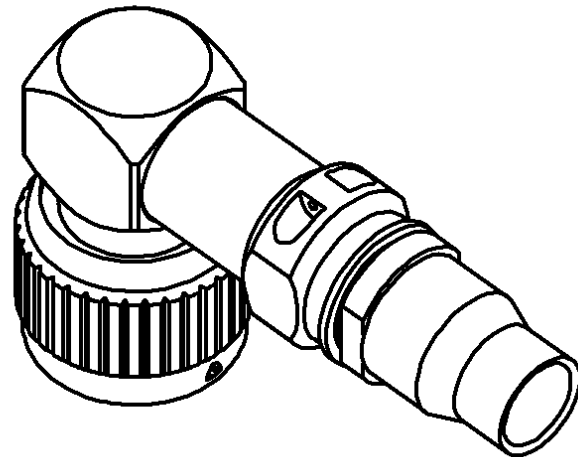
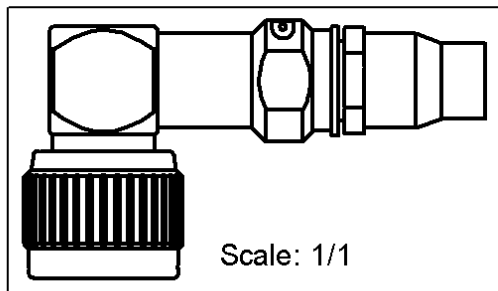
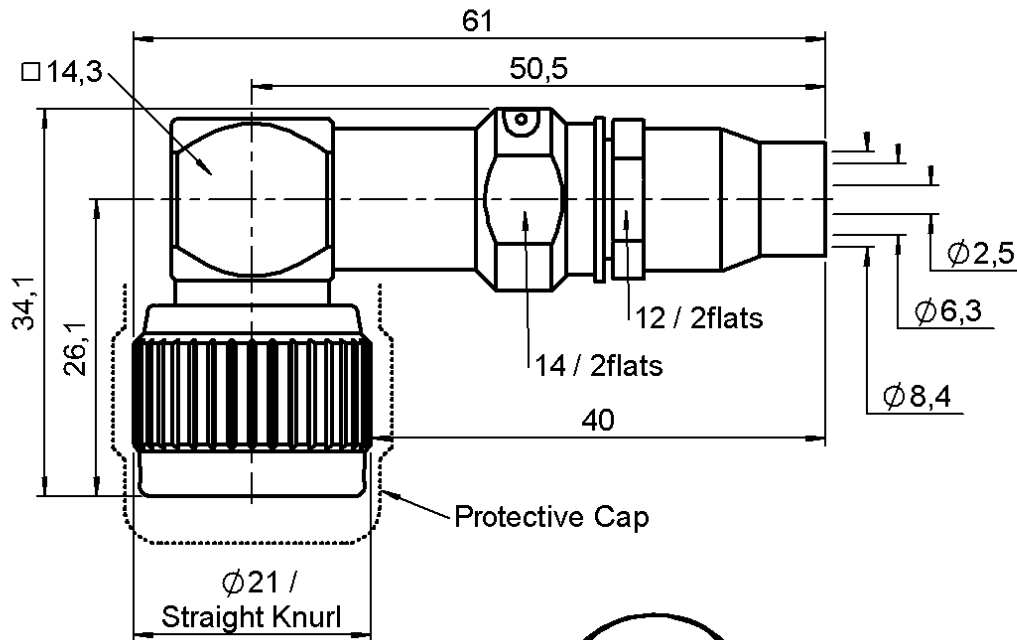

All dimensions are in mm.



COMPONENTS	MATERIALS	PLATINGS (µm)
BODY	BRASS	NICKEL 2
CENTER CONTACT	BERYLLIUM COPPER, BRASS	GOLD 0.5 OVER NICKEL 2
OUTER CONTACT	BRASS	NICKEL 2
INSULATOR	PTFE	
GASKET	SILICONE RUBBER	
OTHERS PARTS	BRASS	NICKEL 2
-	-	-
-	-	-

Issue : 0708 K

In the effort to improve our products, we reserve the right to make changes judged to be necessary.



RIGHT ANGLE PLUG CRIMP TYPE

CABLE 8.07/50

R161.194.000

Series : N

PACKAGING

Standard	Unit	Other
50	'W' option	Contact us

ELECTRICAL CHARACTERISTICS

Impedance	50	Ω
Frequency	0-3	GHz
VSWR	1.20 + 0,0000	x F(GHz) Maxi
Insertion loss	0.07	$\sqrt{F}(\text{GHz})$ dB Maxi
RF leakage	- (101	- F(GHz)) dB mini
Voltage rating	850	Veff Maxi
Dielectric withstanding voltage	1500	Veff mini
Insulation resistance	5000	M Ω mini

MECHANICAL CHARACTERISTICS

Center contact retention	
Axial force – Mating end	27 N mini
Axial force – Opposite end	27 N mini
Torque	NA N.cm mini

Recommended torque	
Mating	130 N.cm
Panel nut	NA N.cm
Clamp nut	370 N.cm
A/F clamp nut	12,0000 mm

Mating life	500 Cycles mini
Weight	67,7000 g

ENVIRONMENTAL

Operating temperature	-55/+155 °C
Hermetic seal	NA Atm.cm3/s
Panel leakage	NA

SPECIFICATION**ASNE0462-K -0693 1 00****CABLE ASSEMBLY**

Stripping	a	b	c	d	e	f
mm	9,00	8,00	26,0	0,00	0,00	0,00

Assembly instruction :

Recommended cable(s)
50 MFCFB FTX

Cable retention

- pull off	400 N mini
- torque	NA N.cm

TOOLING

Part Number	Description	Hexagon
.	.	.
282.291	CRIMPING TOOL M22520/1-01	2x4 (pos. 8)
282.997	LOCATOR	red
282.247	CRIMPING DIE M 22520/5-61	10.9
R282.293.000	CRIMPING TOOL M22520/5-01	-

OTHERS CHARACTERISTICS

-

Issue : 0708 K

In the effort to improve our products, we reserve the right to make changes judged to be necessary.



RIGHT ANGLE PLUG CRIMP TYPE

CABLE 8.07/50

R161.194.000

Series : N

COMPONENTS

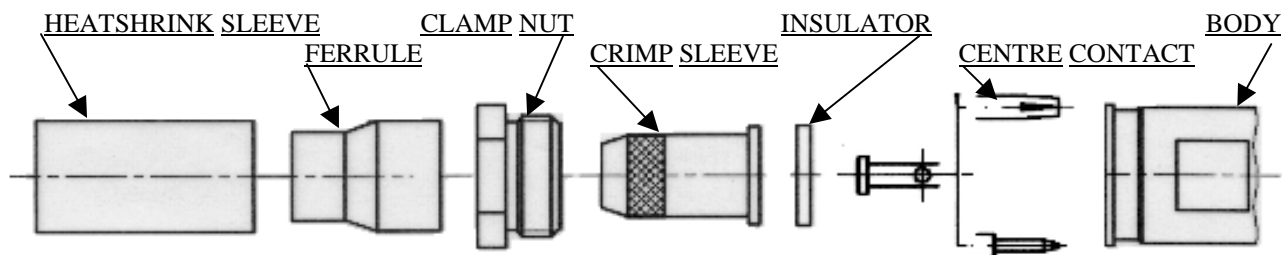

1

Slide onto the cable the heatshrink and the ferrule.
Strip the cable.

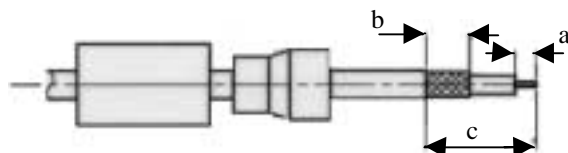

2

Slide the clamp nut onto the crimp sleeve.
Slide sub-assembly under the braid.
Slide ferrule over the braid against clamp nut. (In direction F)
Crimp the ferrule with crimping tool + dies

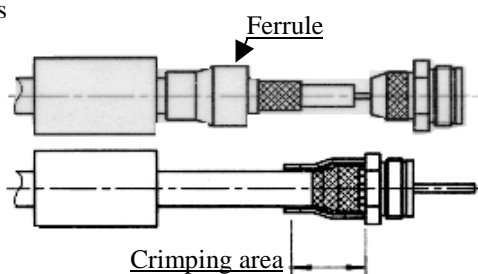

3

Cut the dielectric flush to crimp sleeve.
Mount insulator against crimp sleeve.

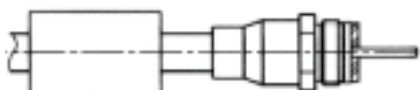

4

Slide the centre contact onto the cable inner conductor against insulator.
Crimp centre contact with the crimping tool and the positioner.

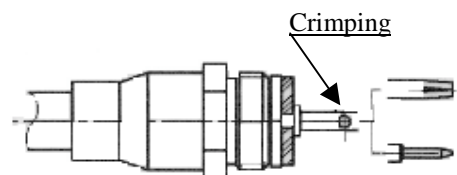

Heatshrink sleeve not shown

5

Screw sub-assembly into the connector body.
(recommended coupling see the connector TDS)
Slide sleeve over ferrule and heatshrink sleeve in the place.

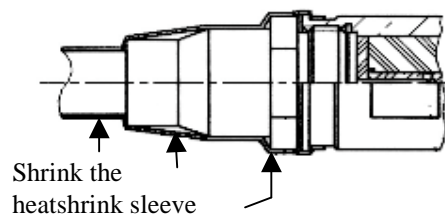

Issue : 0708 K

In the effort to improve our products, we reserve the right to make changes judged to be necessary.

